

* PL2200 Maintenance



* Customers can put some grease on pivot points (red circle place), with brass or gunmetal bushings.



* Let's maintain your machine!

PL2200 HARDWARE
(shown in actual size)

A[1PCS]

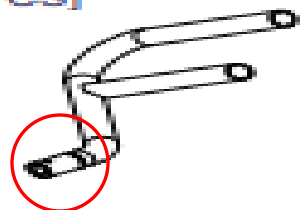

B[1PCS]

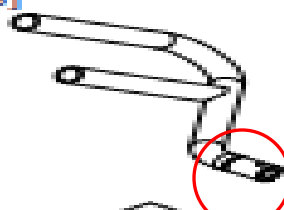

C[1PCS]

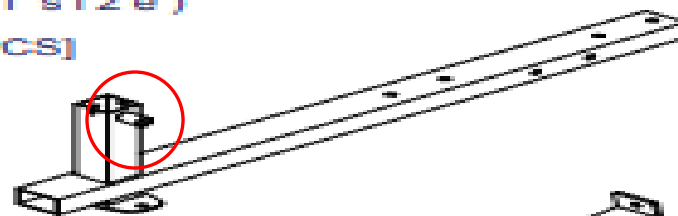

D[1PCS]



E[1PCS]



F[1PCS]

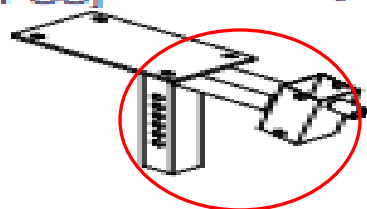

G[1PCS]

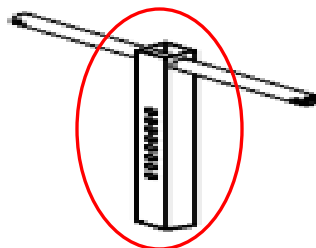

H[1PCS]

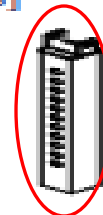

I[1PCS]



J[1PCS]

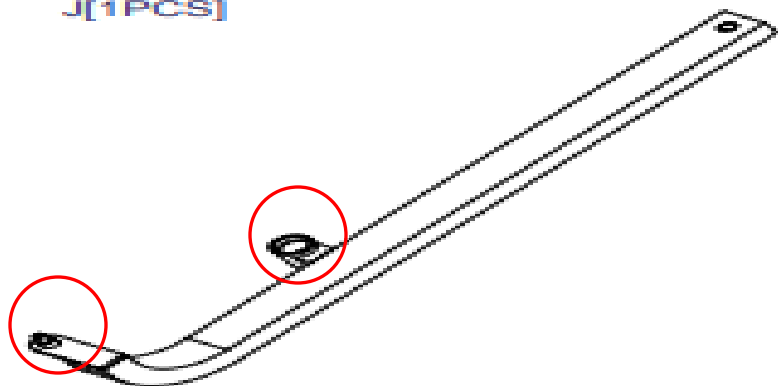

K[1PCS]

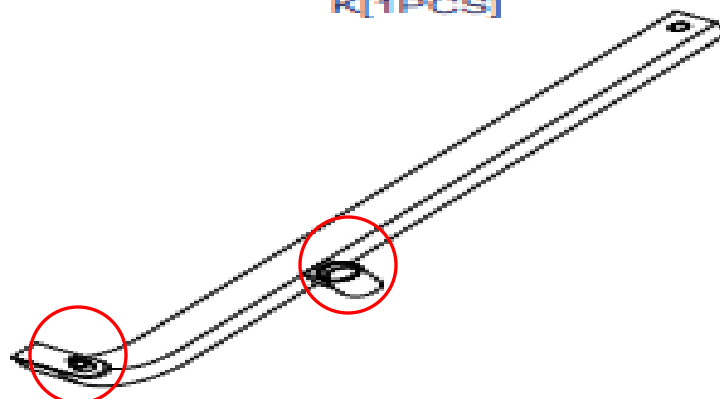

PL2200 HARDWARE
(shown in actual size)

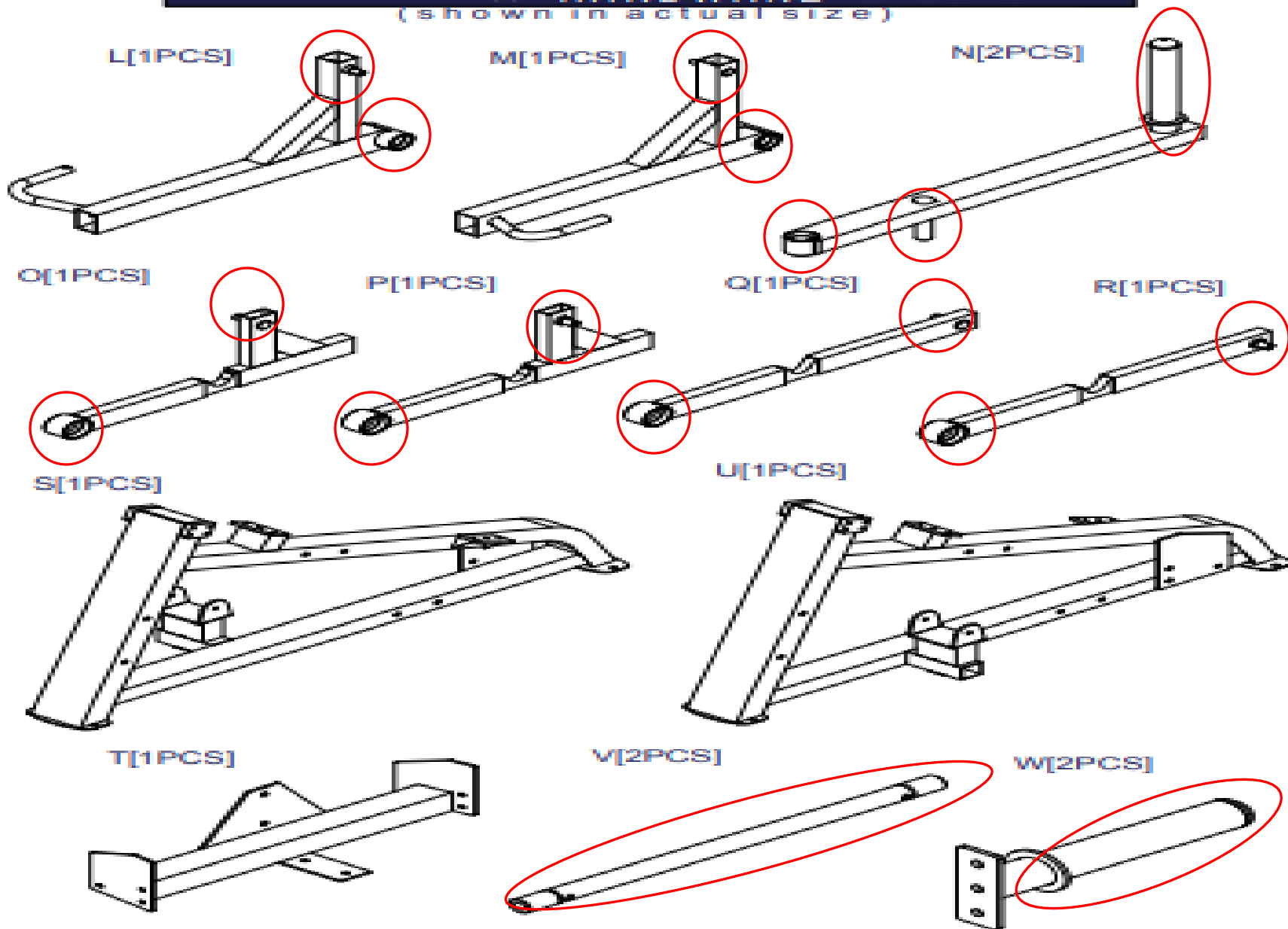

PL2200 HARDWARE
(shown in actual size)

X[1PCS]

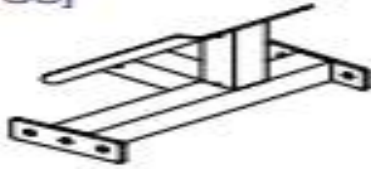

Y[1PCS]

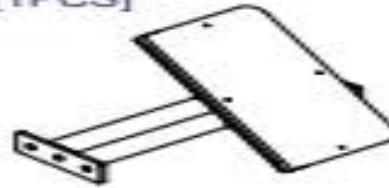

Z[2PCS]

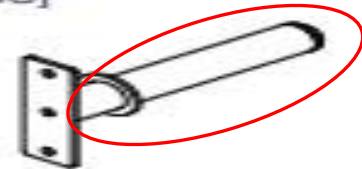

Z1[2PCS]
8220276



Z2[3PCS]
8313082



Z3[1PCS]
8313066



Z4[1PCS]
9111073



Z5[1PCS]
9121078

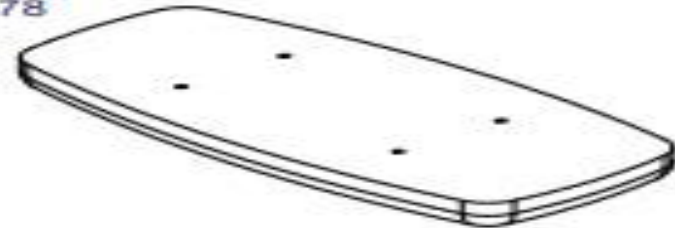

Z6[4PCS]
8312062



Z7[4PCS]
8313243



Z8[2PCS]
8313246



Z9[1PCS]
8830023



Z10[2PCS]
8360184



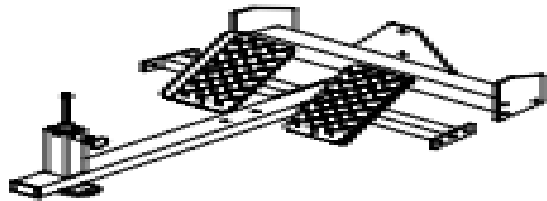

Above shows STEP 1
assembled and completed

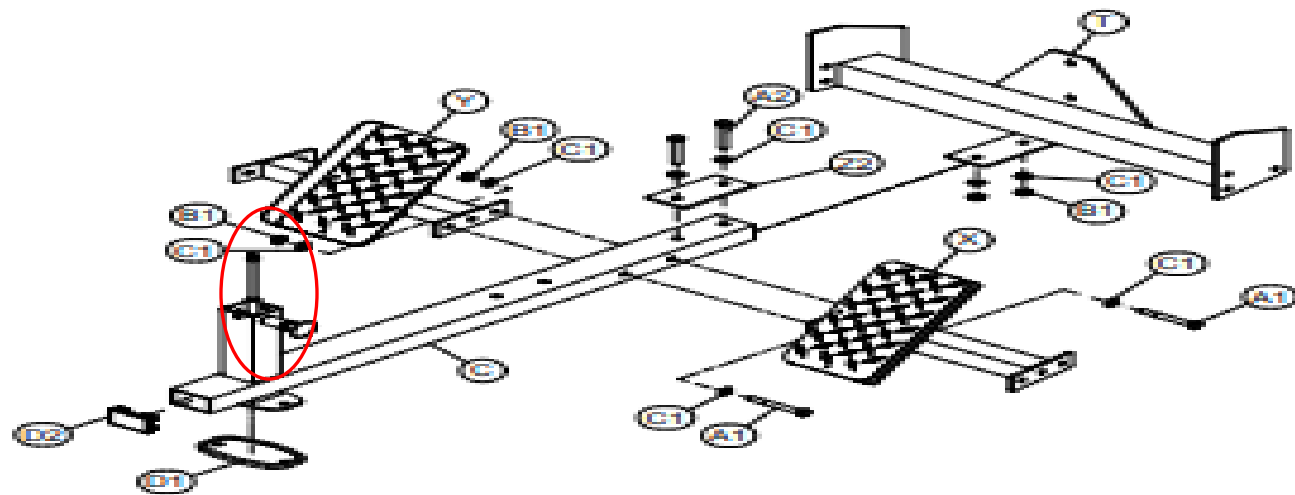

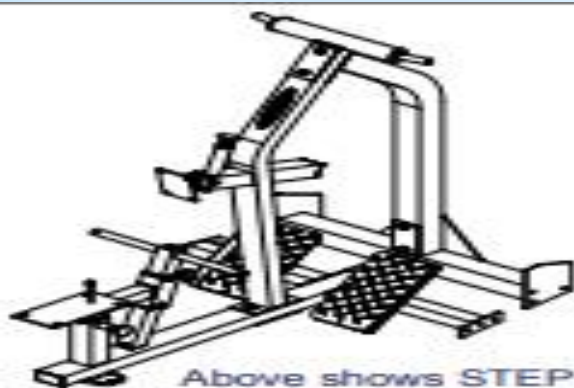

Above shows STEP 2
assembled and completed

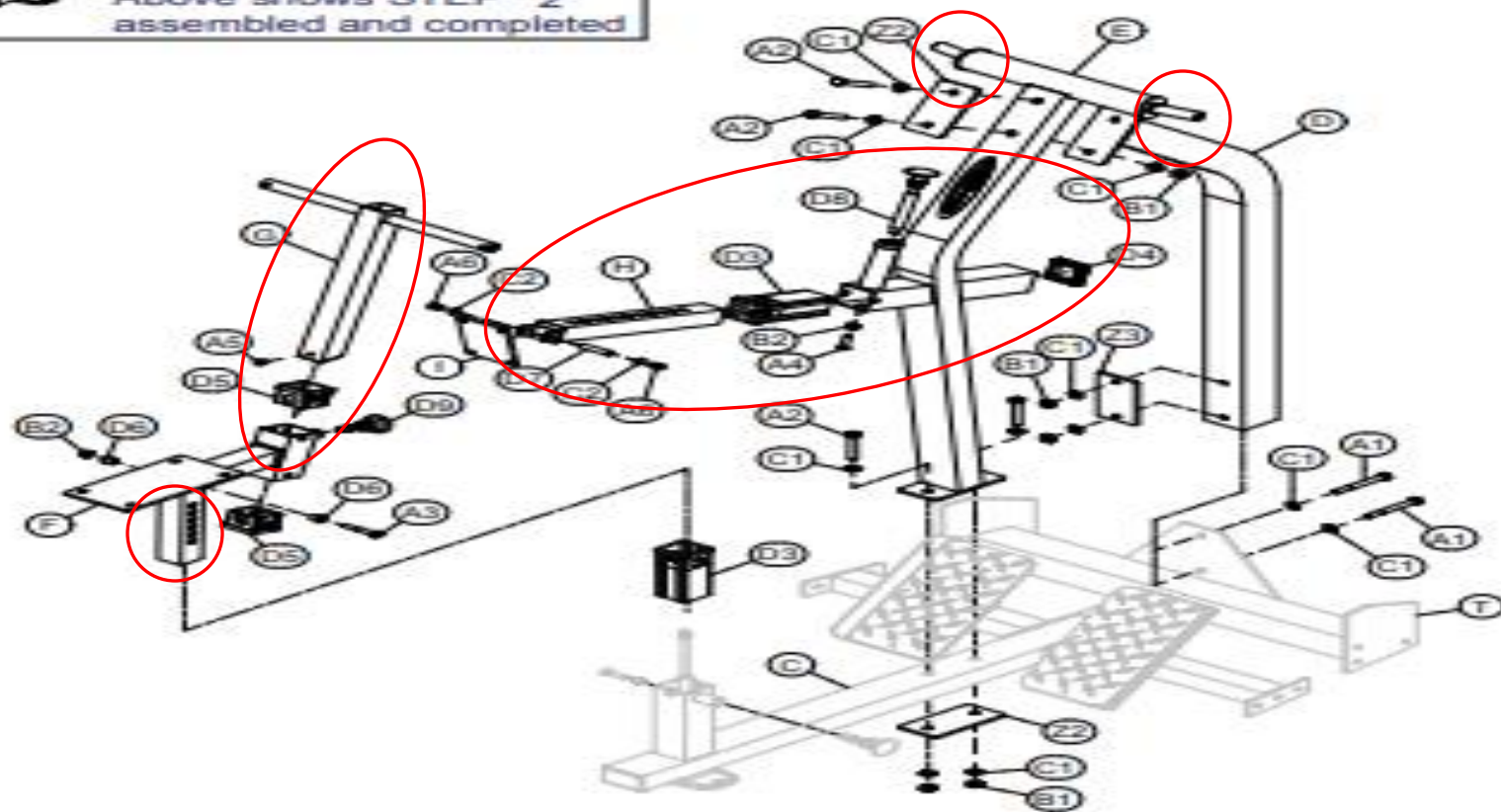

STEP

3



Above shows STEP 3
assembled and completed

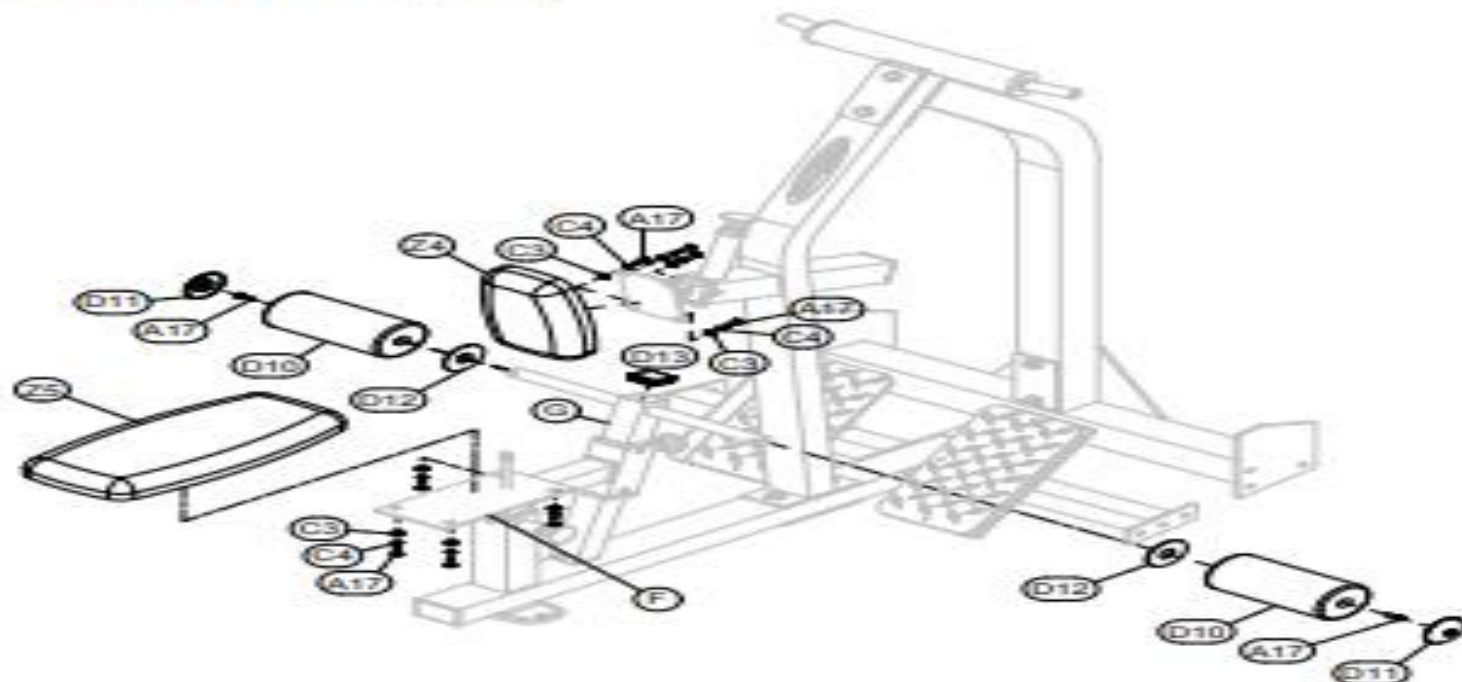

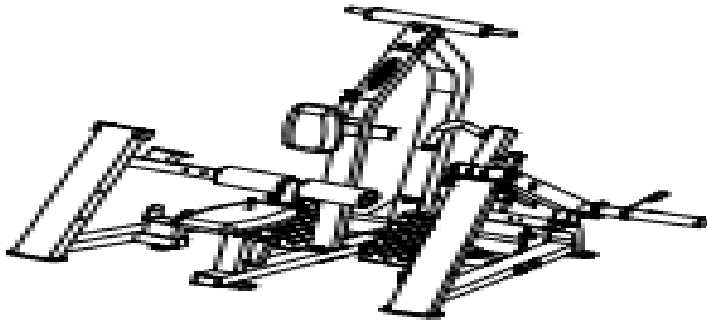

Above shows STEP 4
assembled and completed

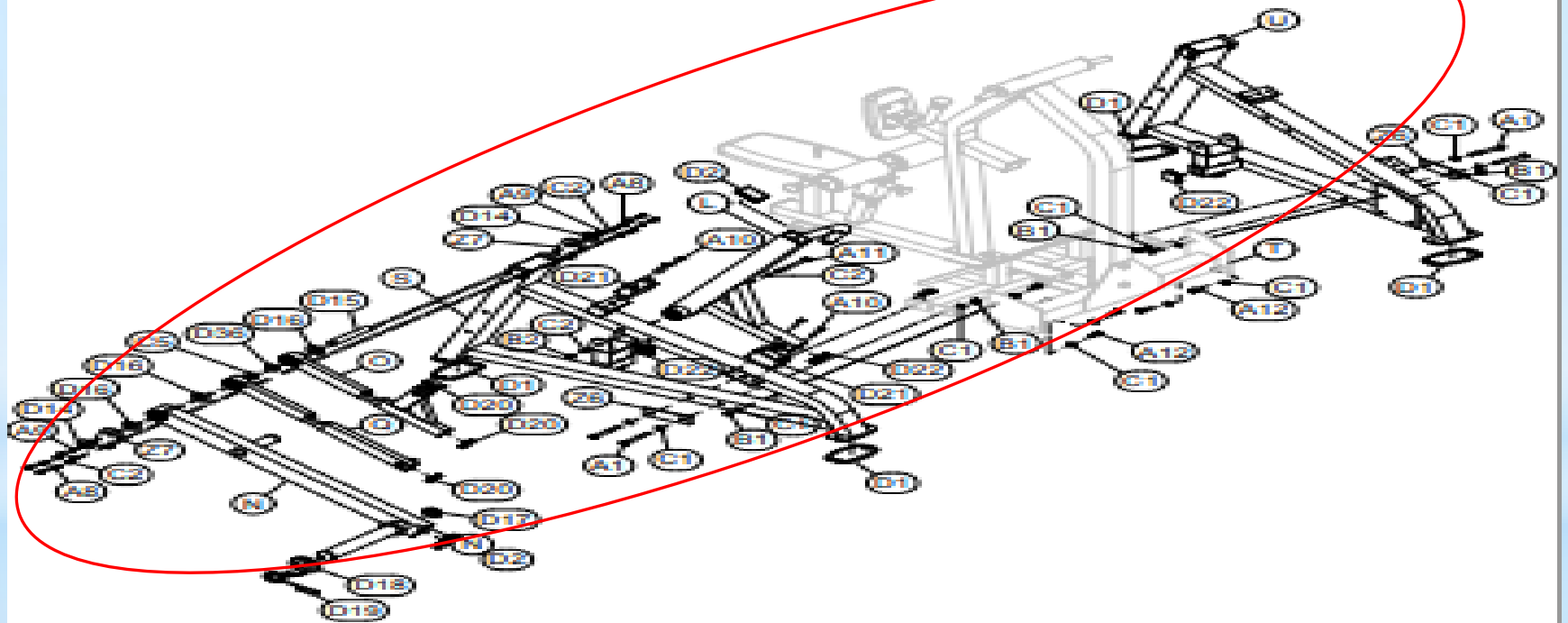

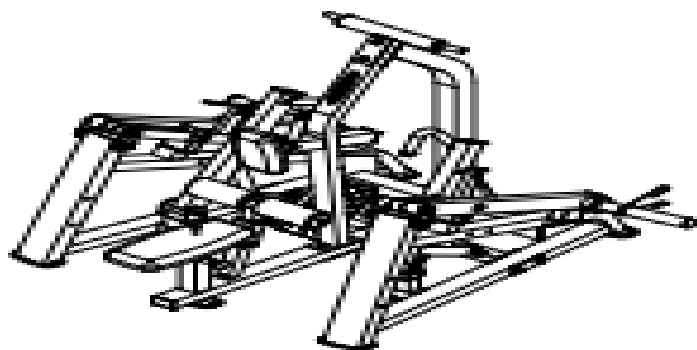

Above shows STEP 5 assembled and completed

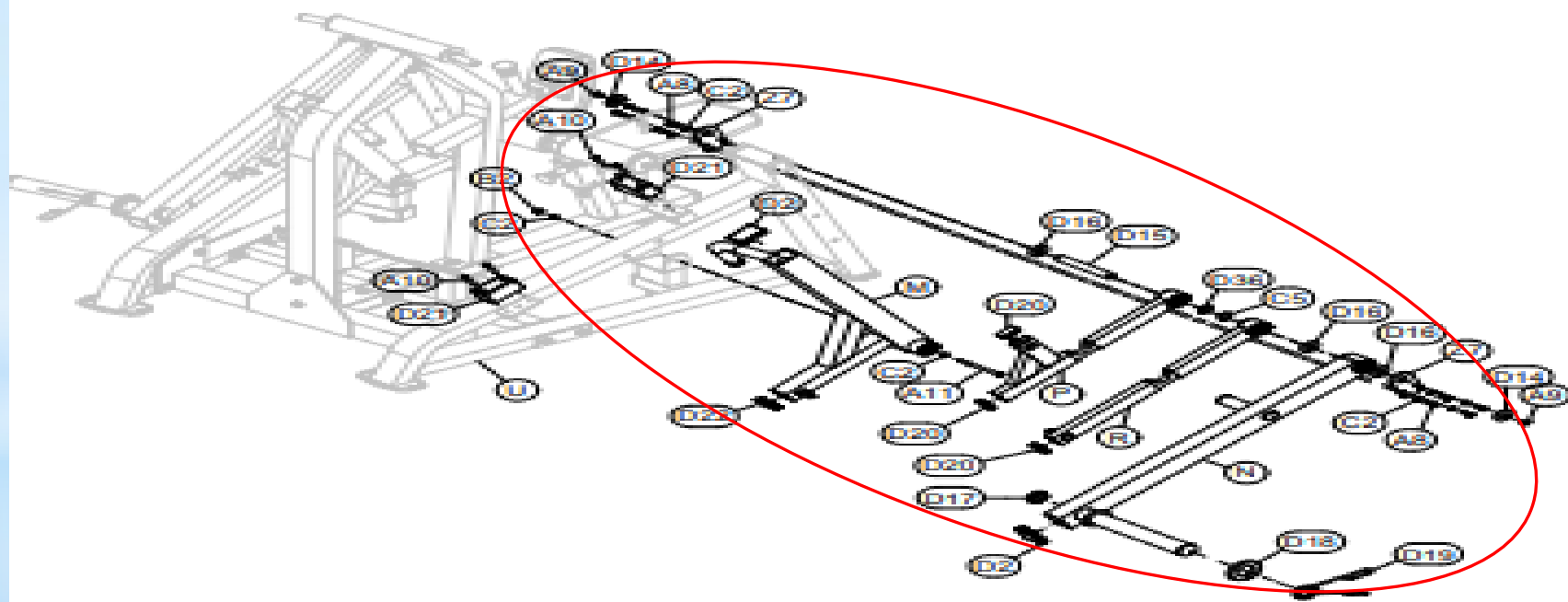



Above shows STEP 6
assembled and completed

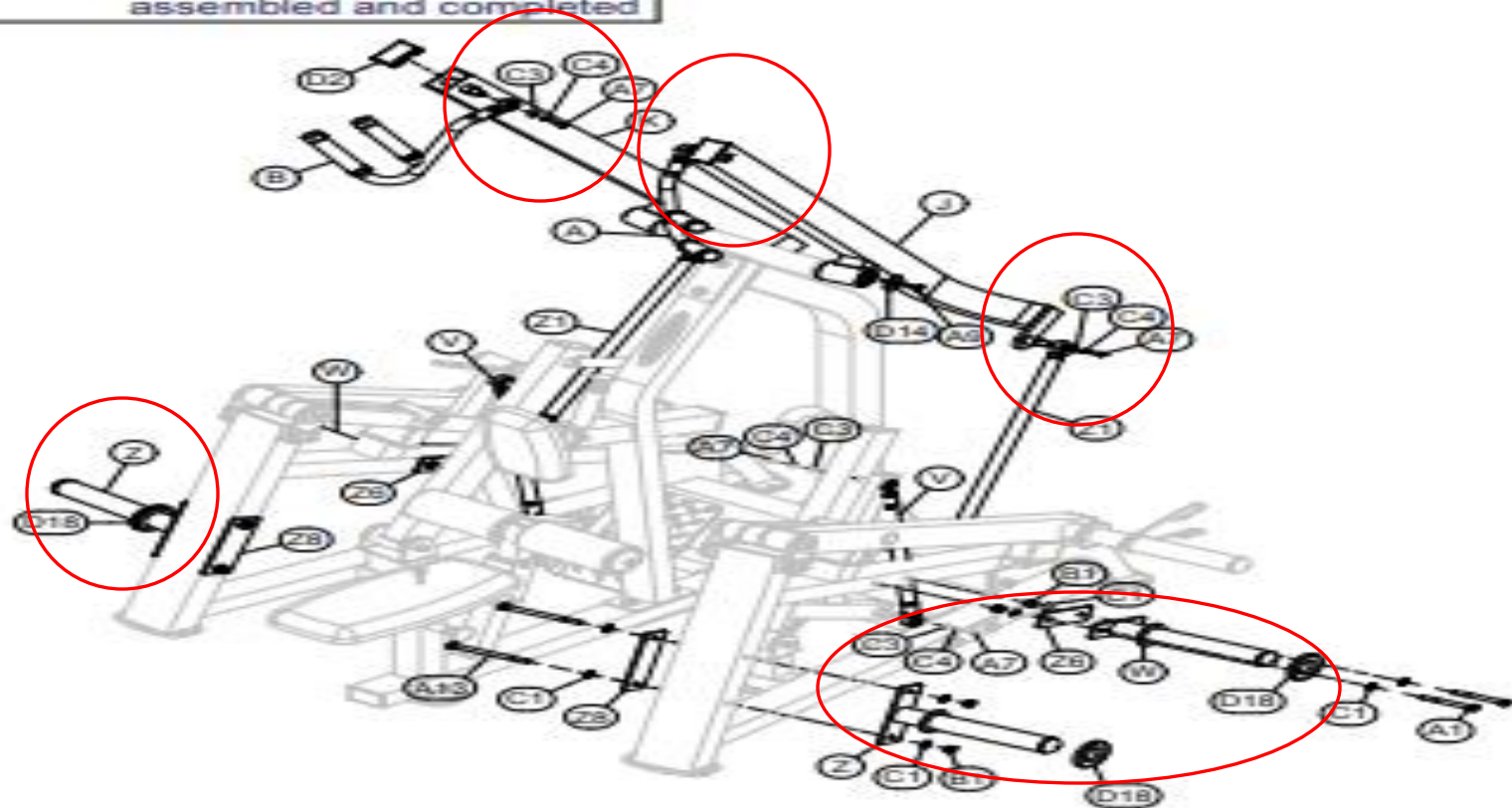

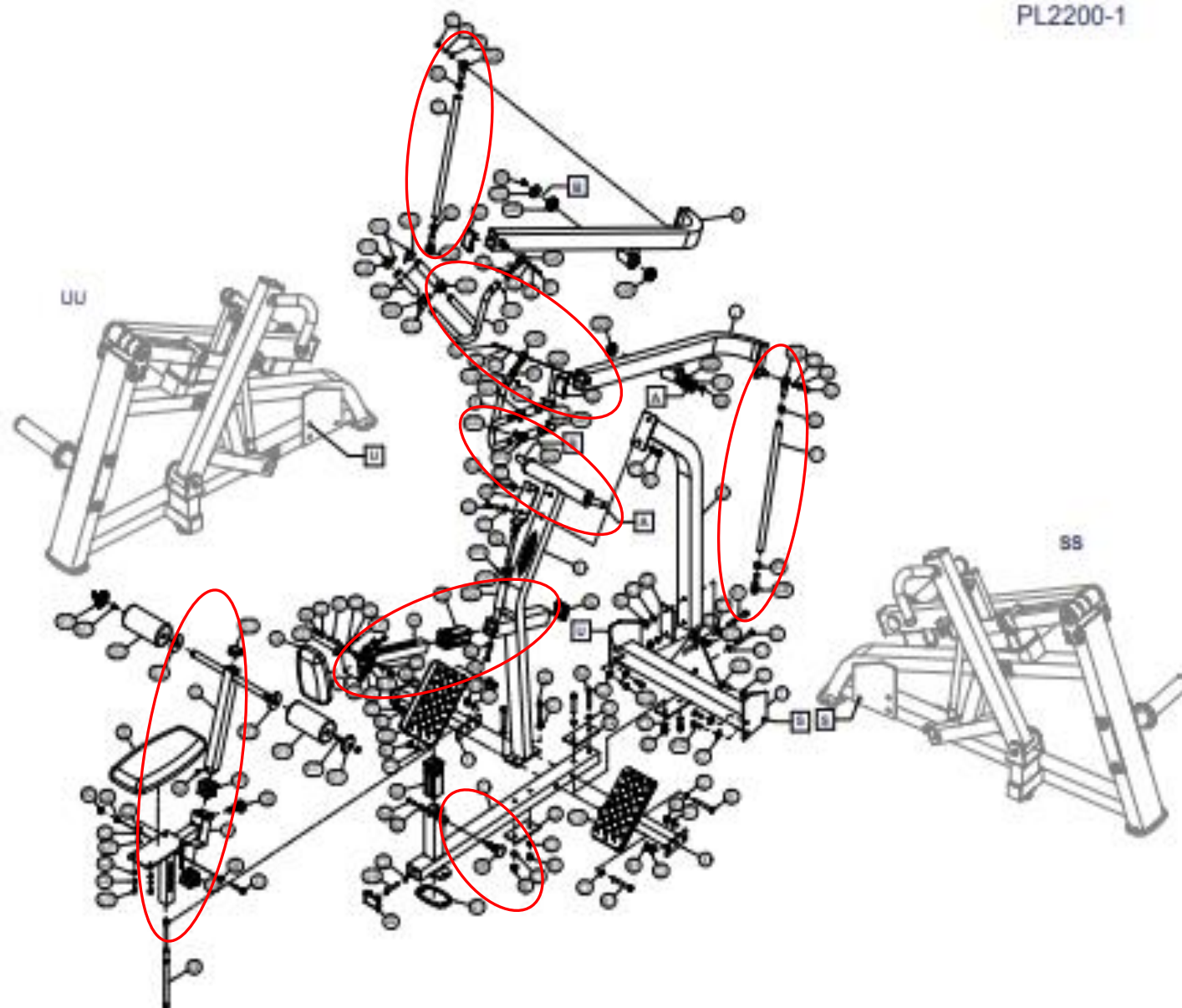

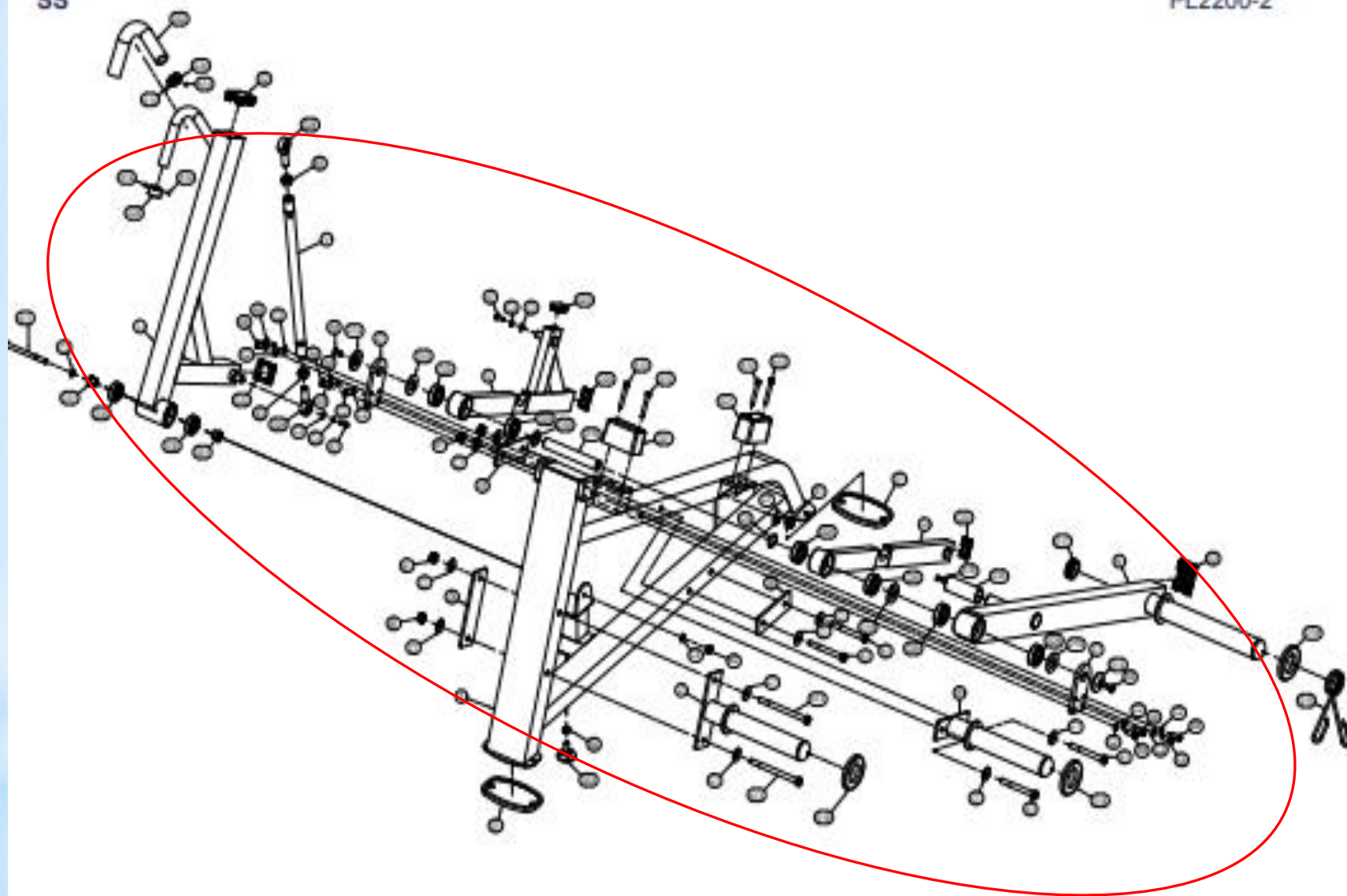

UU

PL2200-3

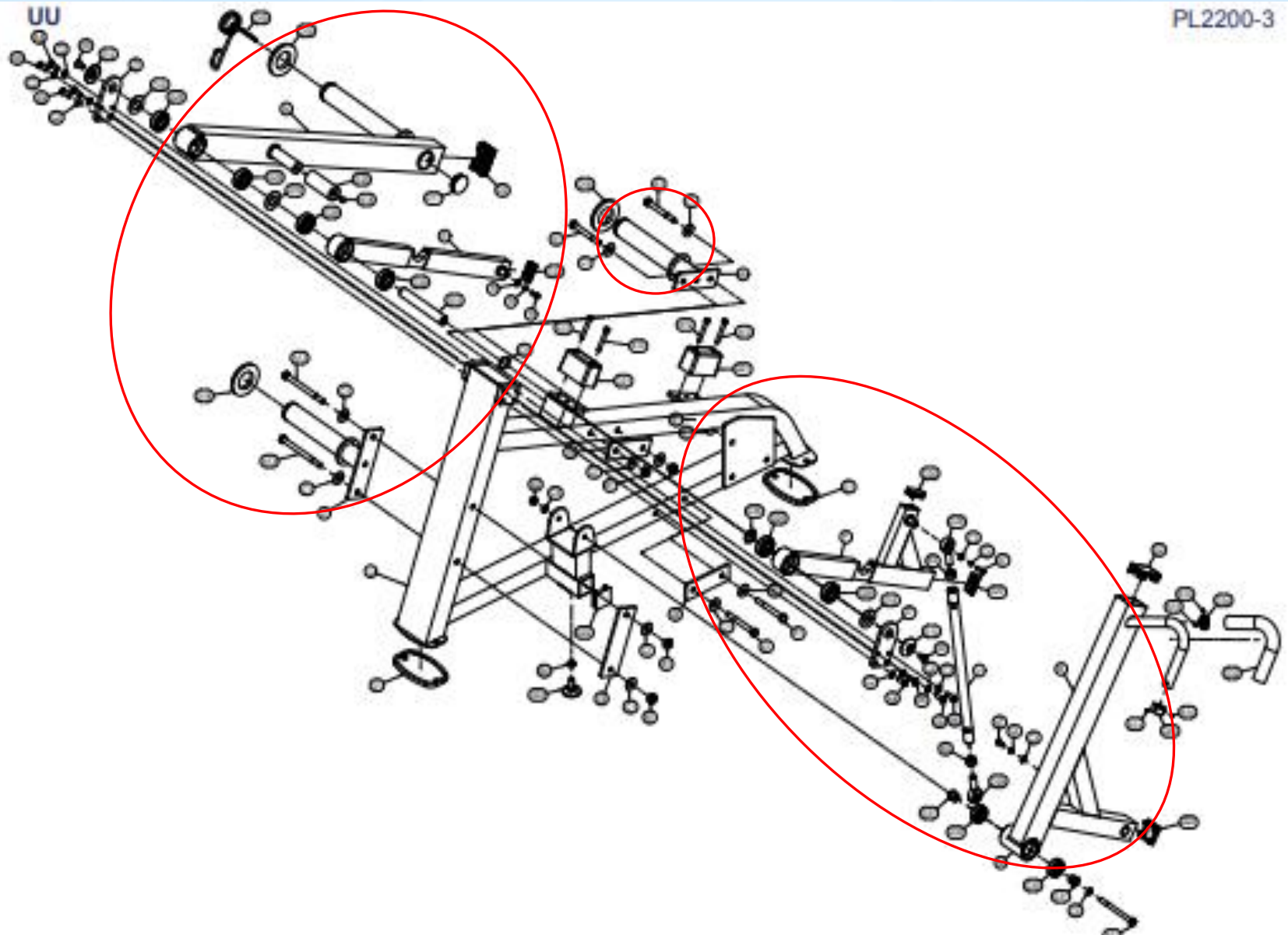

*Well done!

